



AIR QUALITY MONITOR A1 INSTRUCTION

Headquarter:

15A08, Block B, Building 103, Huizhong Lane, Chaoyang District, Beijing, China

Factory address:

169 Xuesong Road, National High-Tech zone, Zhengzhou, 450001, China

Tel: +86-371-67169566

Email: sales@airradio.cn

Web: <http://www.weiguopay.com>

1 Air Quality Monitor

Air Radio A1, air monitor series products, was designed and published by Beijing Weiguo Technology Co., Ltd.

Please use it with "Air Radio" mobile app

Because the product function is being updated continuously, some items in this instruction may not be available to updated products.

To get the latest User Manual, please go to our website at: <http://www.weiguo.pay.com>



2 Package Checklist

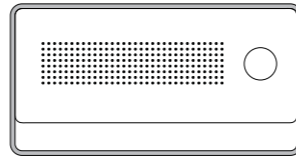

Air Radio A1



USB data cable

3 Product Overview

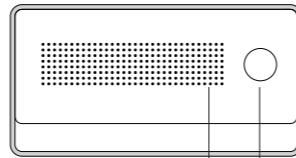

Button

Display Screen

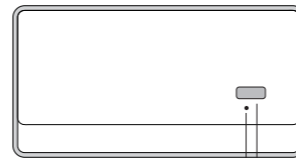

USB Charging Port

WiFi Indicator

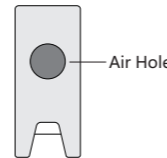

Air Hole

4 Application Environment

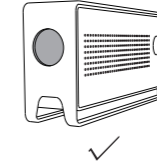

Correct setting

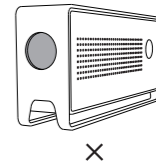

Avoid direct exposure to sunlight

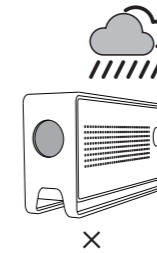

Avoid being invaded by liquid

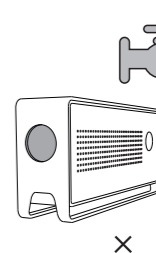

Avoid being placed in humid locations for a long term

5 Application Requirement

To realize complete functions of Air Radio A1, the device should be conducted in proper condition where there is stable WIFI signal, interacted with smart phone from which users can set up family station by mobile App. Note: See "Network Adaptation Method" in the following section.

6 Attention

- 1) Air Radio is compatible with mobile devices with Android or IOS system.
- 2) To connect to mobile devices, Air Radio must connect to the same WIFI as your mobile devices.
- 3) The device requires at least 48 hours of continuous run time under ventilated environment to fully calibrate.

7 Operation

- 1) When power off, press the button once to turn on the device
- 2) When power on, press the button to change the type of air quality parameter to display.
- 3) When power on, press and hold the button for more than 2 seconds to turn off the device.

8 WIFI Indicator

- 1) Consecutive flashes: the device is connecting to the network
- 2) Keep lighting: the device is not connected to WIFI
- 3) No indication: the device is connected to WIFI

9 Let's Get Started to Use

- A** Scan the following QR code to download the mobile App (Skip this step if you have already downloaded the App).
- B** Open the App and log in your account (register firstly if you don't have an account).
- C** After logging in successfully, scan the QR code or type in device number to bind with the device.



http://weigu.airradio.cn/smart/download_link_en.html

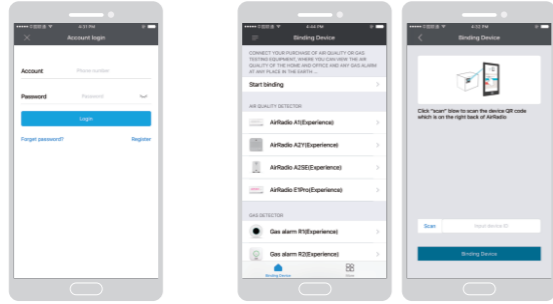

- ★ Be sure that the current mobile device is connected to WIFI

- D** Connect the device to WIFI according to the guidance in the App.
- E** When choosing WIFI hot point, enter the name and password of the WIFI hot point you are going to connect, and touch "bind".
- F** After finishing network connection, checking the air quality Index is available now.



- ★ To configure other Air Radio products, enter the page of My Device and click "+"

- ★ If it is your first time opening the App without configuring the device, enter the page of Binding Device and click Start Binding. Scan the QR code or enter the ID number and fill in with WIFI name and password. Click the network configuration button to configure the network when the device is in the mode of network configuration.

10 Icon Display

Small Icon	Large Icon	Item	Definition
		General air quality index	Current general air quality index monitored
		PM2.5	Current PM2.5 concentration monitored
		VOC	Current VOC concentration monitored
		Co2	Current CO2 concentration monitored
		TEMPERATURE	Current temperature monitored
		HUMIDITY	Current humidity monitored
		WIFI	Device is in the state of network adaptation
		AC POWER	USB power supply mode
		BATTERY	Battery power supply mode

11 Specification

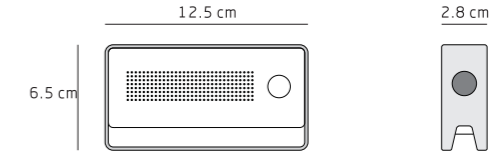

• Appearance

Height: 6.5cm Length: 12.5cm Width: 2.8cm

Screen Size: Height: 1.9cm Width: 7.9cm weight: 173g

• Industrial Design

The external structure applies anode aluminum oxide technique to ABS engineering plastic.

• Sensors and Measurement

PM2.5/PM10

Range: 0~1000ug/m³

Accuracy: ±10%

Resolution: 1ug/m³

Temperature

Range: -20~70°C

Accuracy: ±2°C

Resolution: 1°C

Humidity

Range: 0~100%RH

Accuracy: ±5%RH

Resolution: 1%RH

CO₂

Range: 0~5000ppm

Accuracy: ±(50ppm+5%Displayed value)

VOC

Range: 0~100